

Cellular Slider Installation Instruction - Center Split

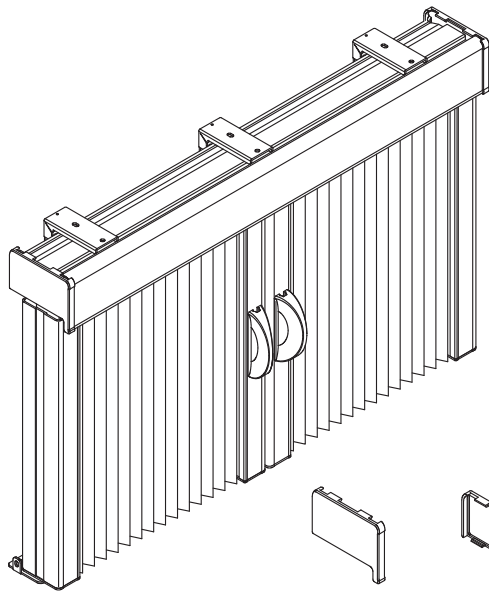

Installation Parts

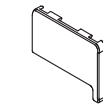

#PLP4115L
Headrail End Cap



#PLP4115R
Headrail End Cap



#2233022
Stationary Rail
Bottom Bracket

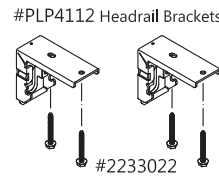

#PLP4112 Headrail Brackets

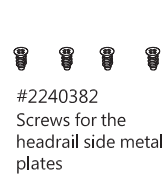

#2240382
Screws for the
headrail side metal
plates

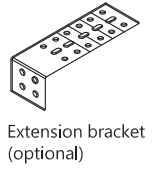

Extension bracket
(optional)

Headrail Brackets quantities:
 $72" \leq W$ - 2 brackets
 $72" < W \leq 108"$ - 3 brackets
 $108" < W \leq 120"$ - 4 brackets

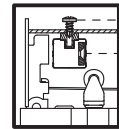

#2232152
PLP4127-1+Magnet*1

STEP 1.

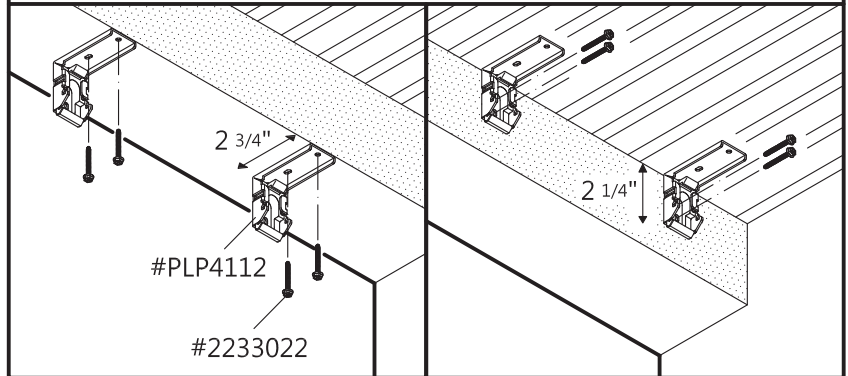

STEP 2.

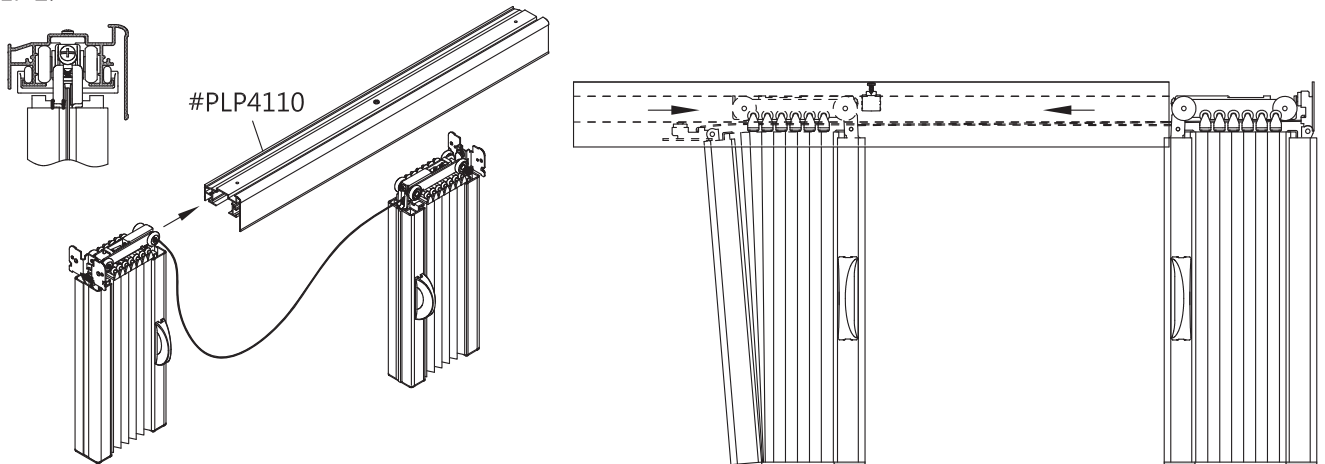

STEP 3. Tight the screws onto the brackets at the top of the stationary rails.

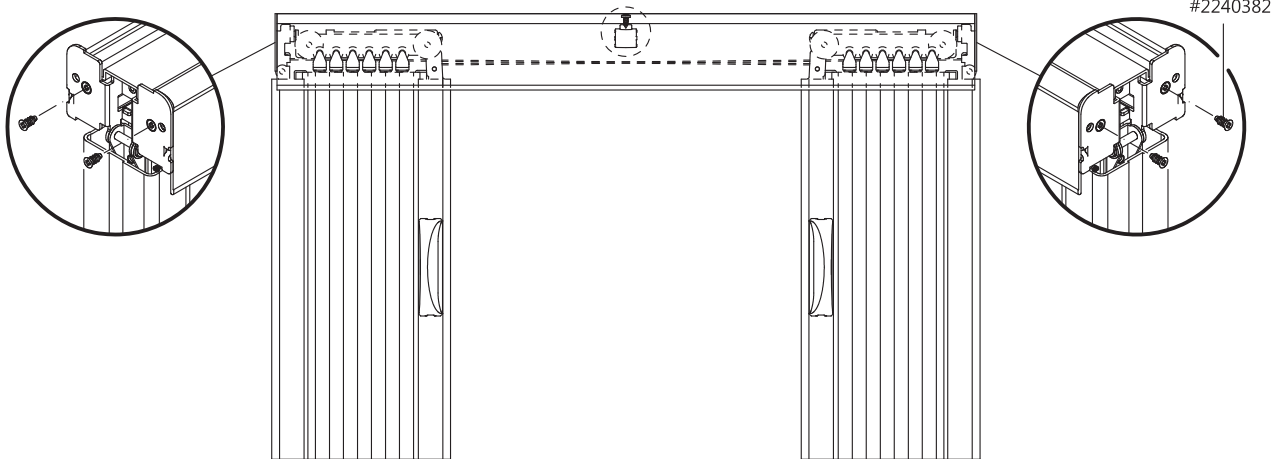

Cellular Slider Installation Instruction - Center Split

STEP 4.

When there are side stoppers on your shade, please tight the screws to the stoppers completely.

If there is no side stopper, please skip this step.

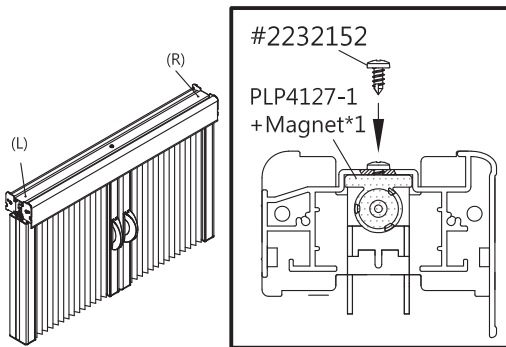
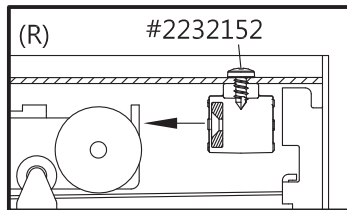
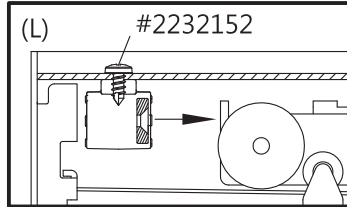

STEP 5.

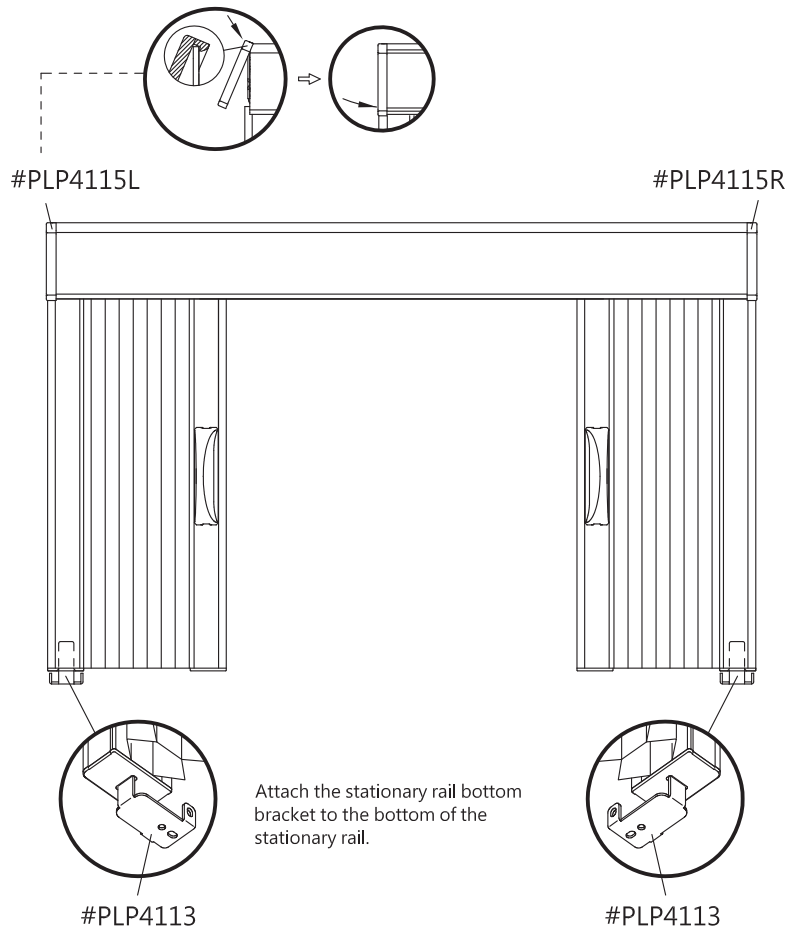

STEP 6.

Attach the headrail to the brackets.

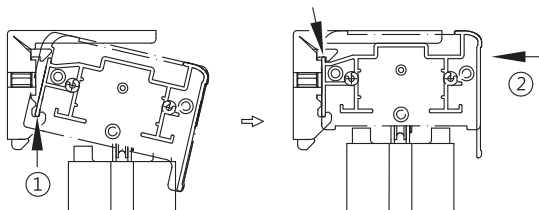

Remove the headrail from the brackets.

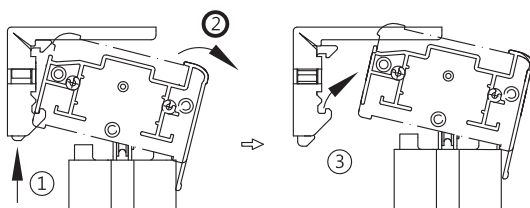

STEP 7.

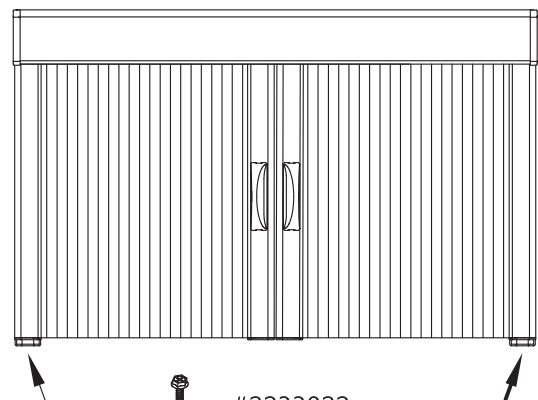

Mount the stationary rail bottom bracket to the floor or to the side wall. You may use your own screws if needed.

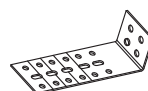

Optional Extension bracket is available when request.

Cellular Slider Installation Instruction - Center Split

Adjust the tension of the moving rails to ensure:

- When two moving rails attached to each other, the moving rails won't bounce toward the stationary rail.
- The moving rail stays at the location you desire.

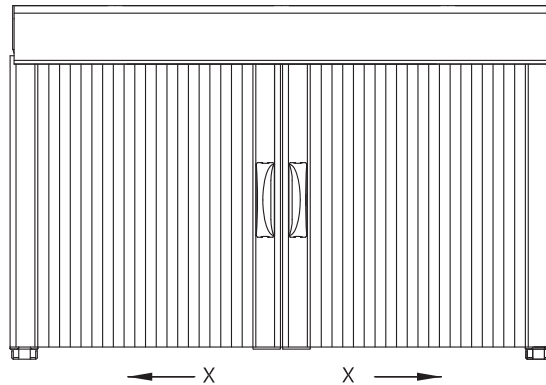

- If the moving rails can not stay the location you desire or bounce toward the stationary rails, please adjust the location of the cord stop as right and below.

STEP 1.
Pull out the Cord stop

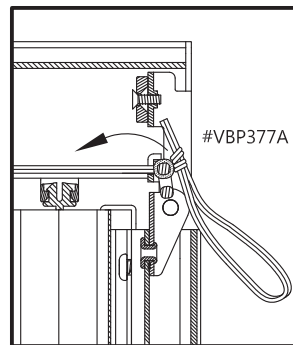

STEP 2.
Release the knot

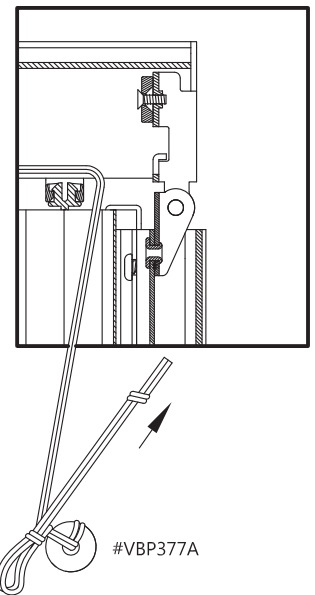

STEP 3.
Adjust the location
of the Cord Stop

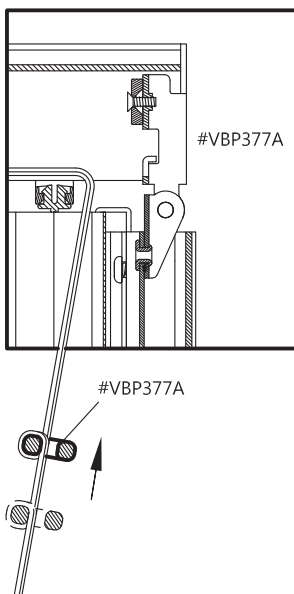

STEP 4.
Knot the Cord Stop

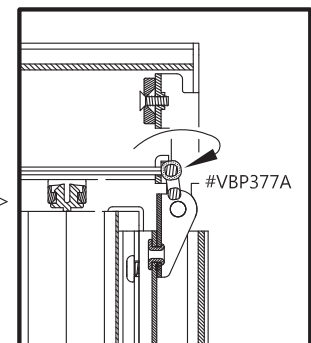
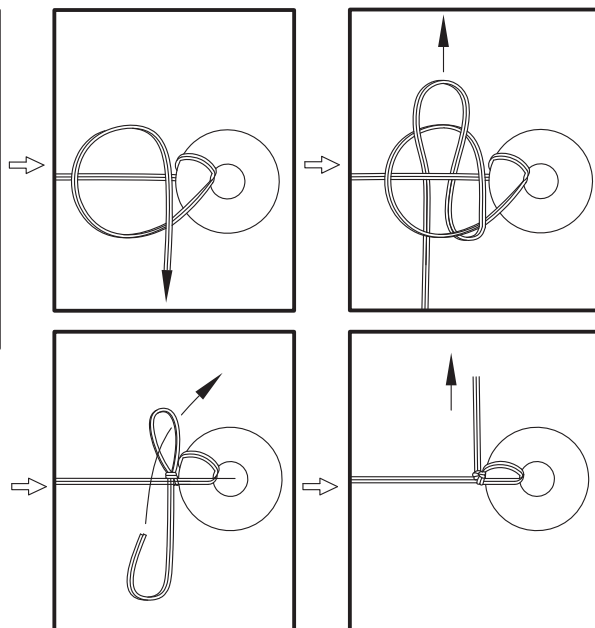

Cellular Slider Installation Instruction - Center Split

The vertical alignment

- Adjust the moving rail to make it straight.

A1. To adjust the bottom end of the moving rail to the left

A2. To adjust the bottom end of the moving rail to the right

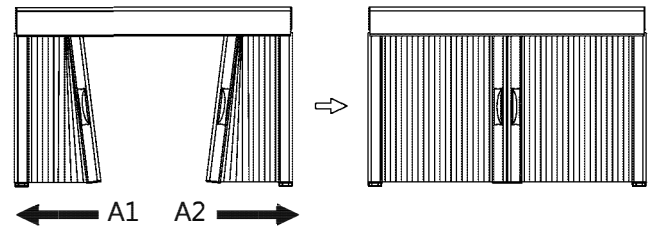

STEP 1. Loosen the outside screw 1/2 turn.

A1.

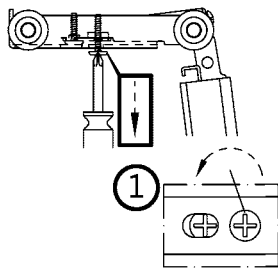

STEP 2. Loosen the inside screw 1/2 turn.

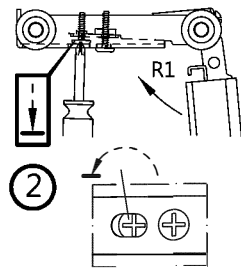

STEP 3. Loosen the outside screw 1/2 turn if needed.

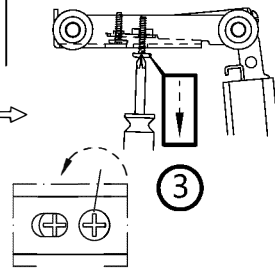

STEP 4. Loosen the inside screw 1/2 turn if needed. Repeat step1 & step2 until the moving rail straight. Tighten the outside screw slightly after alignment.

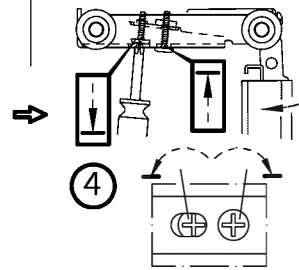

A2.

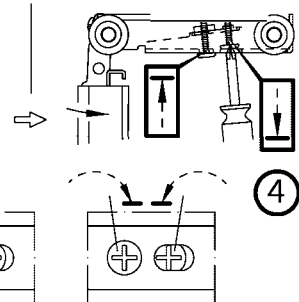
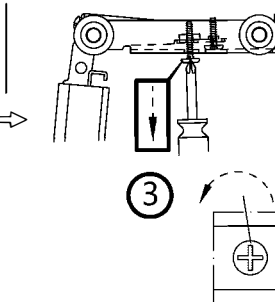
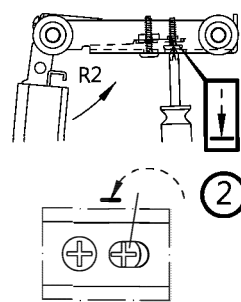
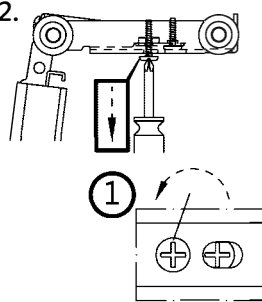

B1. To adjust the bottom end of the moving rail to the right

B2. To adjust the bottom end of the moving rail to the left

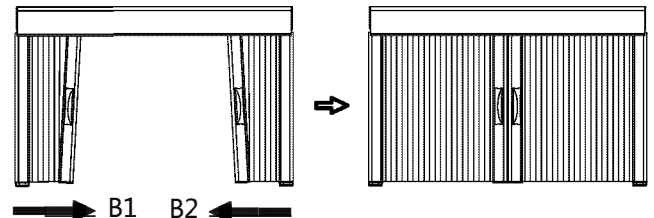

STEP 1. Tighten the inside screw 1/2 turn.

B1.

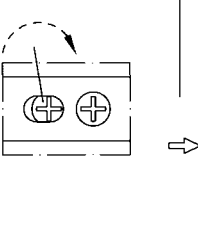
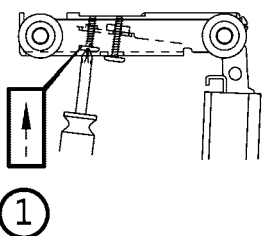

STEP 2. Check the moving rail alignment.

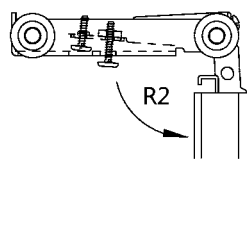

STEP 3. Tighten the outside screw 1/2 turn. Repeat step 1 & step 2 until the moving rail straight. Loosen the screw slightly after alignment.

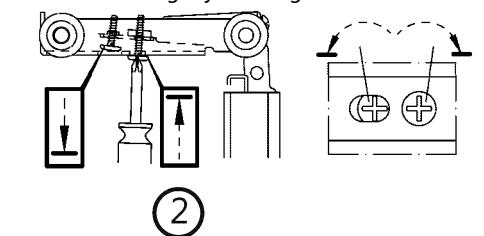

B2.

