

Cellular Slider Installation Instructions

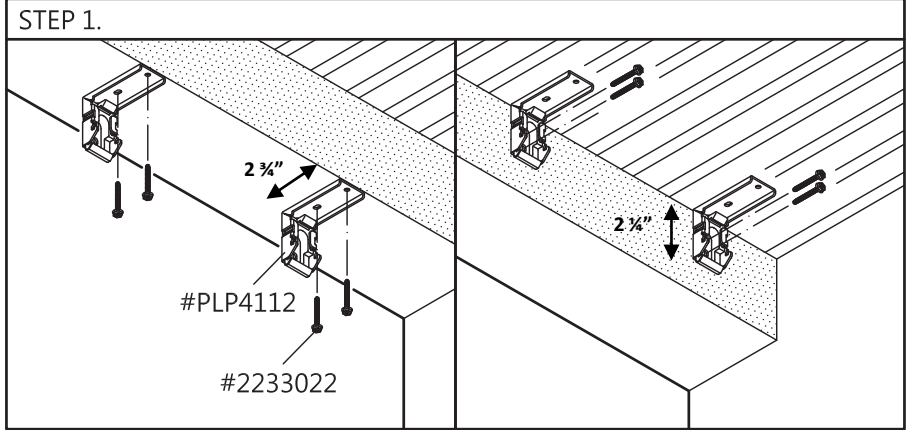

Installation Parts

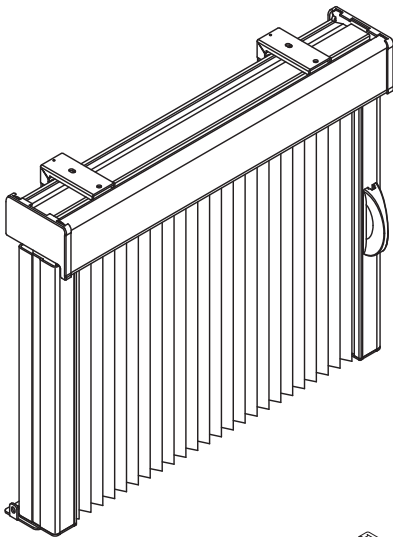
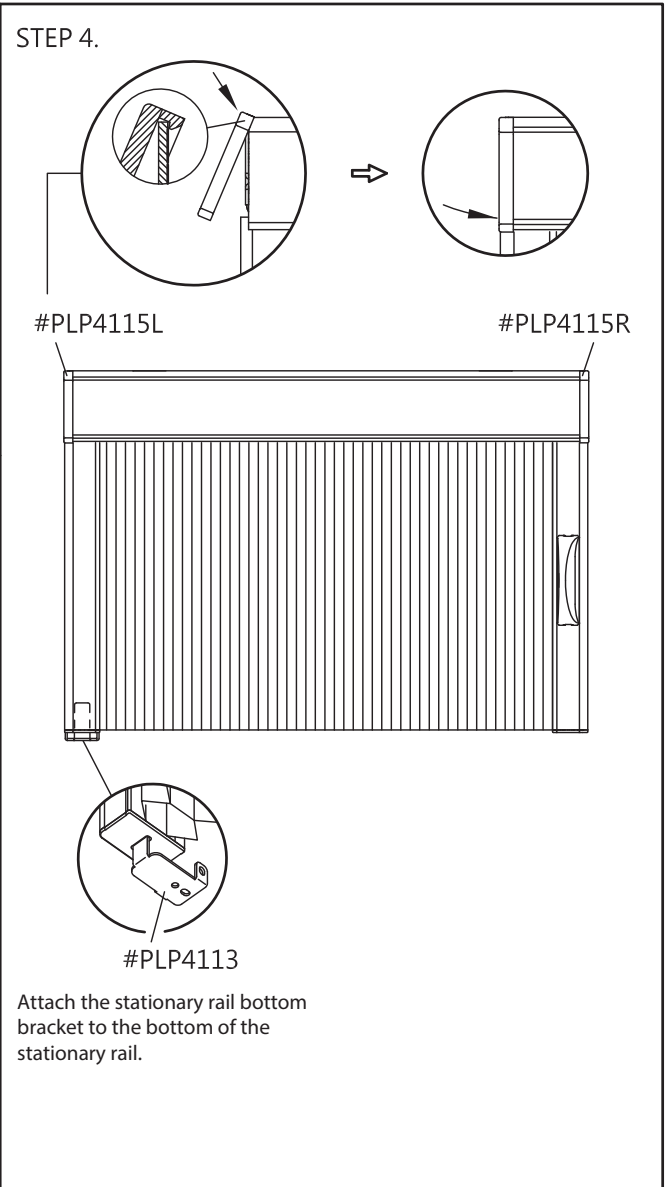
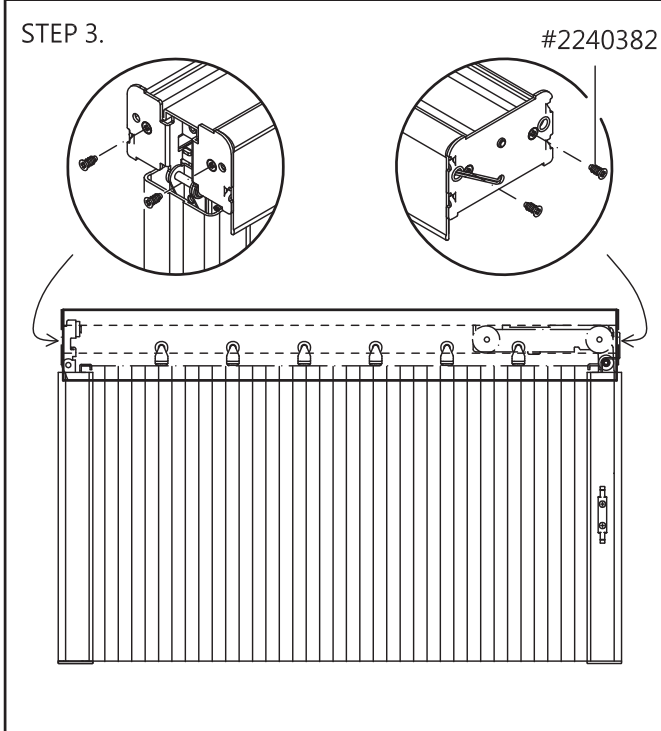
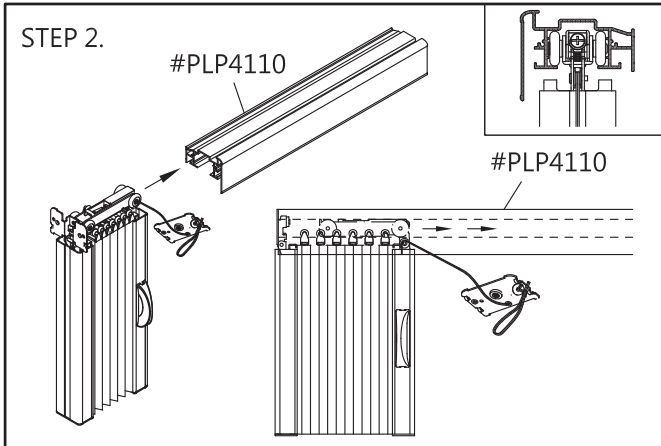
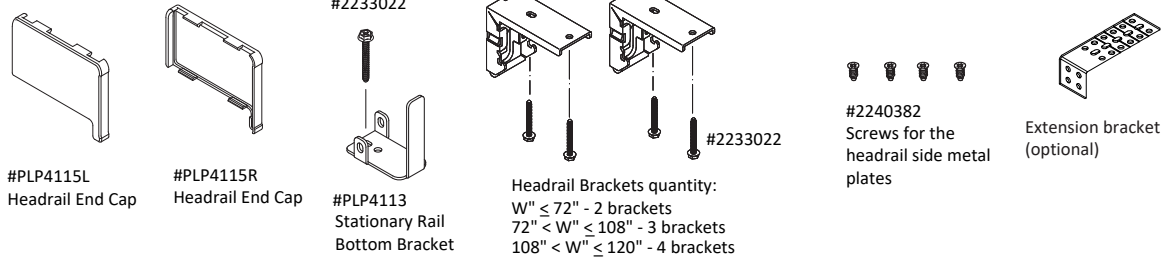

Cellular Slider Installation Instruction

STEP 5.

Attach the headrail to the brackets.

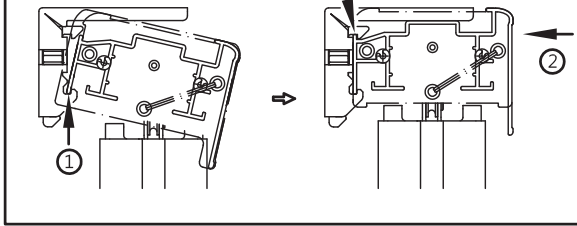

Remove the headrail from the brackets.

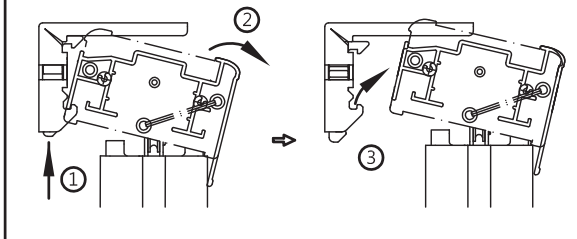

STEP 6.

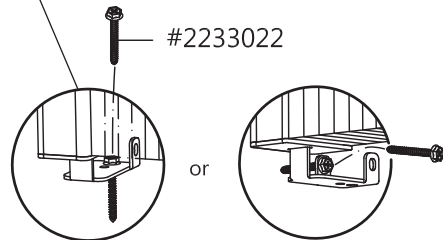
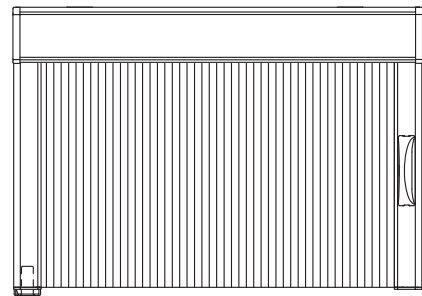

Mount the stationary rail bottom bracket to the floor or to the side wall. You may use your own screws if needed.



Optional Extension bracket is available when request.

Adjust the tension of the moving rail to ensure:

- The moving rail won't bounce toward the stationary rail
- The moving rail stays at the location you desire.

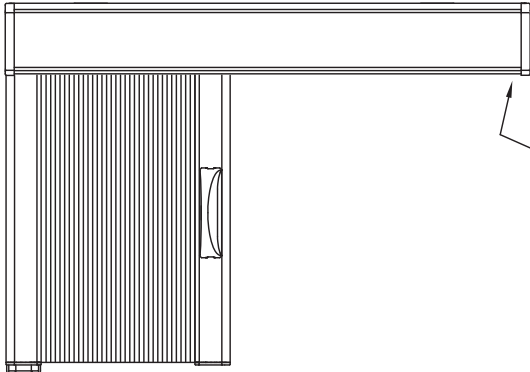

STEP 1.

Pull out the Cord Stop

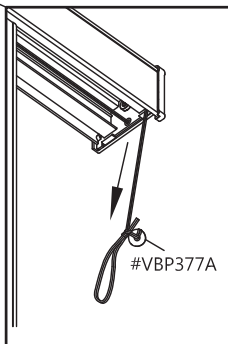

STEP 2.

Release the knot

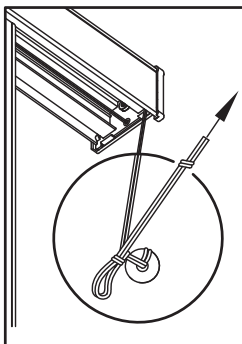

STEP 3.

Adjust the location of the Cord Stop

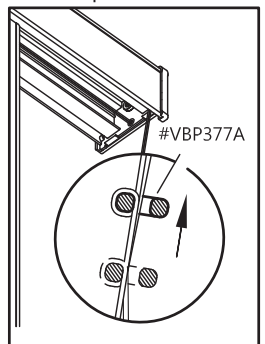

STEP 4.

Knot the Cord Stop

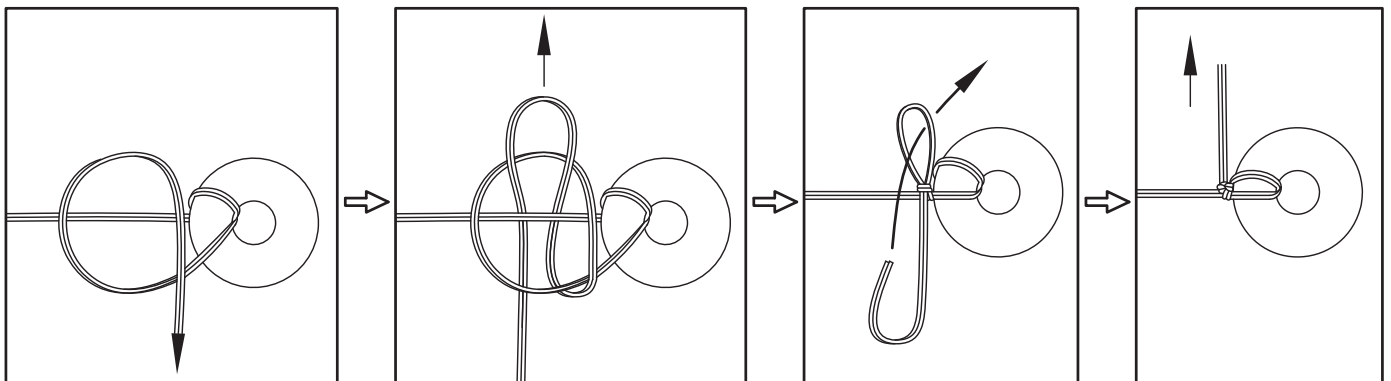

Cellular Slider Installation Instructions

The vertical alignment

- Adjust the moving rail to make it straight

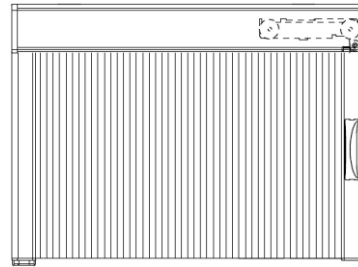

A. To adjust the bottom end of the moving rail to the left

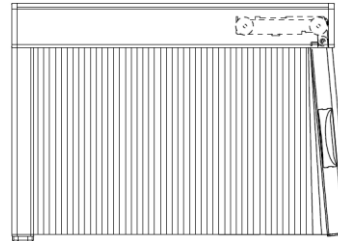

Step1. loosen the outside screw ½ turn.

Step2. loosen the inside screw ½ turn.

Step3. loosen the outside screw ½ turn if needed.

Step4. loosen the inside screw ½ turn if needed. Repeat step1 & step2 until the moving rail straight. Tighten the outside screw slightly after alignment.

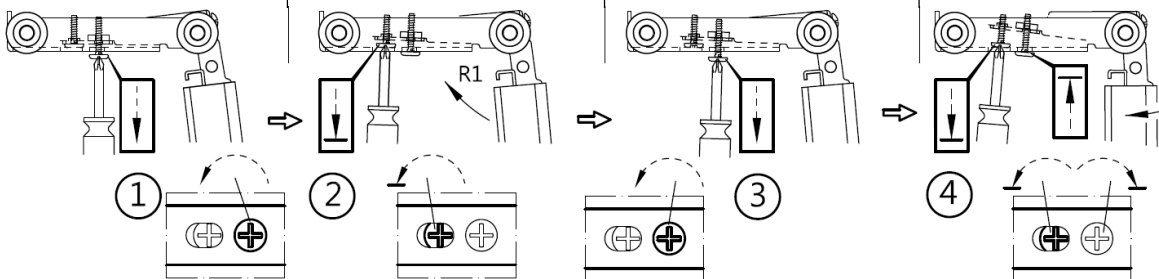

B. To adjust the bottom end of the moving rail to the right

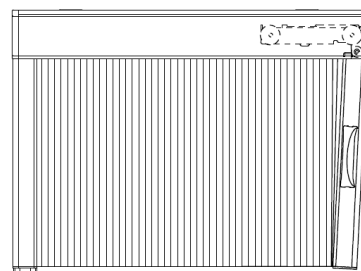

Step1. tighten the inside screw ½ turn.

Step2. Check the moving rail alignment.

Step3. Tighten the outside screw ½ turn. Repeat step1 & step2 until the moving rail straight. Loosen the inside screw slightly after alignment.

