

# Rollease Automate Top Down Bottom Up Cellular Shades

## - Installation and User Guide

### Installation

**1. Identify your cellular shade and parts** (your parts may vary, depending on the custom request & size of the shade you are purchasing.)

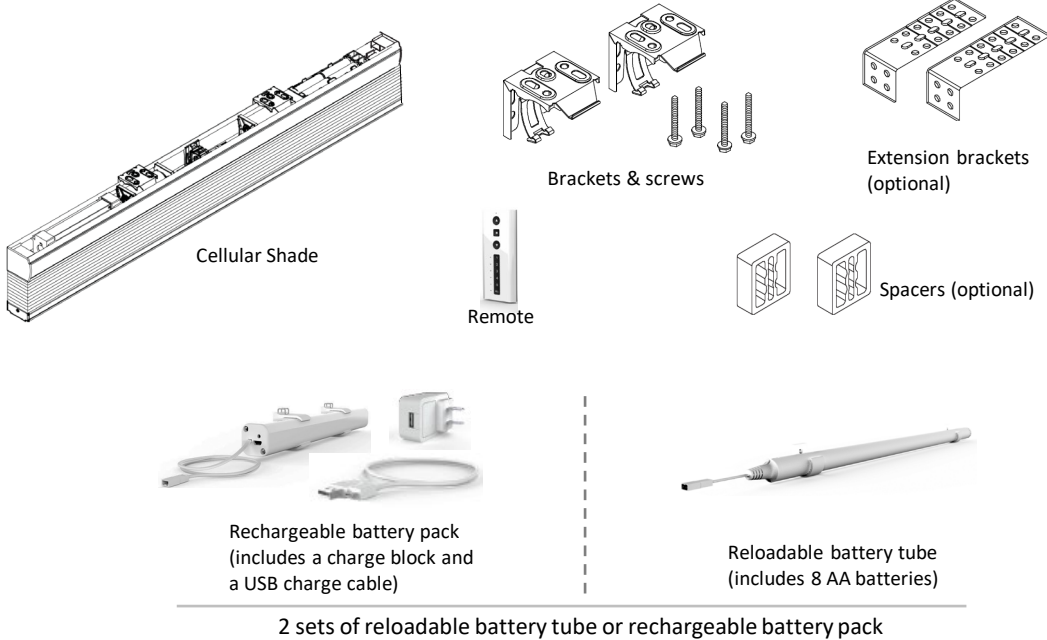

**2. Tools you may need** (not included)

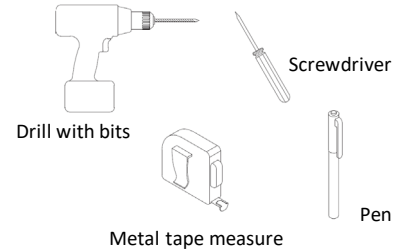

Shade width	Qty of the mounting brackets
$18'' \leq W < 48''$	2
$48'' \leq W < 67''$	3
$67'' \leq W < 96''$	4
$96'' \leq W \leq 120''$	5

### 3. Install the brackets

- Mark the bracket locations. Space the brackets evenly and make sure the brackets will not interfere with any mechanism or other internal headrail parts.
- Install the brackets using screws (included) and tighten them completely.
- Make sure all brackets are aligned and level with each other.
- Install the shade with extension brackets (optional)
  - Install the extension bracket with at least 2 screws.
  - Attach the hidden brackets to the extension brackets with the screws.

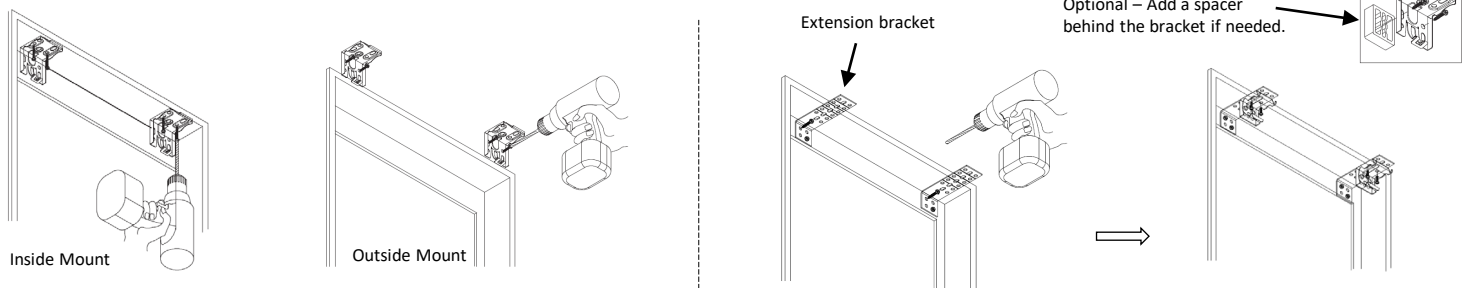

### 4. Install the battery powers (2 sets/ per cellular shade)

- Use the included screws and battery brackets to install the battery power to the location you desire.
- Follow the installation instruction inside the battery box.

### 5. Mount the shade onto the brackets

- Connect motor to the battery.

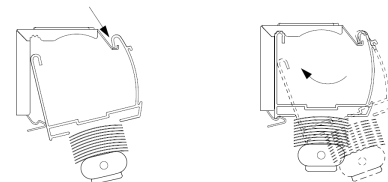

# Rollease Automate Top Down Bottom Up Cellular Shades

## - Installation and User Guide

Enjoy

This motorized shade is already connected to the remote and programmed with Upper and Lower Limits. Option to program "My Favorite Position", follow the instruction inside the remote box. Enjoy your new motorized shade!

## Operation

- The top down bottom up default setting of the remote is CHANNEL 1 controls the middle rail; and CHANNEL 2 controls the bottom rail.
- To lower the shade, always lower the bottom rail first by pressing the channel 2, and then lower the middle rail by pressing the channel 1.
- To raise the shade, start with the middle rail by pressing channel 1, followed by the bottom rail by pressing channel 2.
- **NOTE: THE SHADE SHOULD BE OPERATED PROPERLY TO PREVENT THE CORDS FROM BECOMING LOOSE.**

Rollease motorized TDBU –

The default setting of the remote is CHANNEL 1 controls the middle rail; and CHANNEL 2 controls the bottom rail.

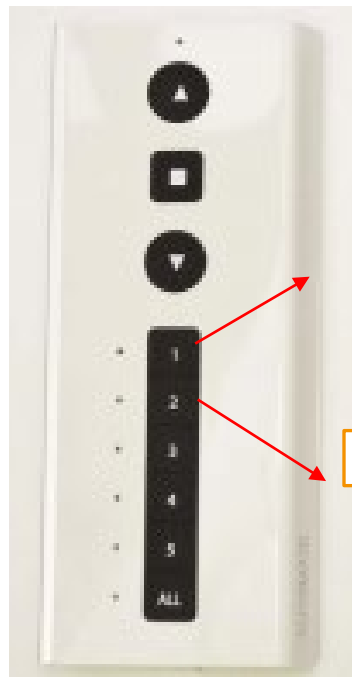

Channel 1 controls the middle rail

Channel 2 controls the bottom rail

## Care and Clean

- Wipe the shade periodically with a soft dust cloth or dusting mitt, or vacuum with a lowest speed.

### Notes

- Do not spill water to the headrail and the remote.
- Do not clean/ operate the motorized shade with wet hands
- The warranty for your shades does not cover damage caused by improper cleaning.
- Changing the batteries won't change the programming setting.

