

Cordless Dual Sheer Shade - **Operation & Troubleshooting**

Operation

To Lower Shade:

Pull straight down on the center of the bottom bar to lower the shade to exact desired position.

To Raise Shade:

Push center of bottom bar up to exact desired position, then release shade.

IMPROPER USE WILL LEAD TO:

Misalignment of panels, creasing or fraying of panel edges, or separation of panels from each other, the bottom bar, or cassette.

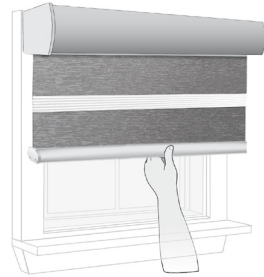

Troubleshooting

Tension Control

This is a fine adjustment control; you may need to rotate the screw 5+ full turns to make any tension changes.

Unable to Raise / Billowing / Drifting Downward

If the shade will not raise, panels billow when raising, or drifts downward instead of staying in a desired position, the tension needs to be increased.

Remove the end cap on the right side of the cassette to access the tensioning screw. Turn the screw to the **LEFT** (Counter-clockwise) to increase tension for stronger pull/ increased hold.

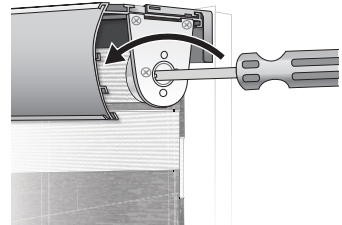

Tension Control: To **INCREASE** tension, turn **LEFT** (Counter-clockwise)

Drifting Upward / Raising Too Quickly

If the shade drifts up or continues to raise after being positioned, the tension needs to be decreased.

Turn the screw to the **RIGHT** (Clockwise) to decrease tension, lessening the strength of the spring.

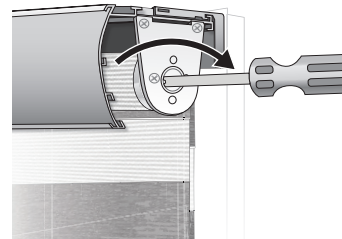

Tension Control: To **DECREASE** tension, turn **RIGHT** (Clockwise)

Cordless Dual Sheer Shade - Operation & Troubleshooting

Troubleshooting Cont.

Shade Fabric is Not Aligned

The back panel of Dual Sheer shades should be perfectly in line with the front panel to ensure proper operation. If the panels are not aligned, it can result in frayed fabric edges or waves in your shade fabric.

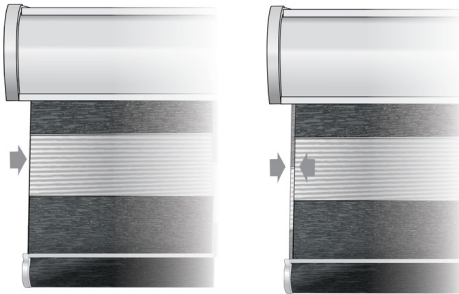

Shade fabric is aligned.

Shade fabric is NOT aligned.

To correct unaligned shade fabric:

1. Start by fully lowering the shade.
2. Gently pull the back fabric panel in line with the front.

Bracket Installation

Waviness may occur if the brackets are not installed properly. Ensure brackets have been properly installed:

1. Install Dual Sheer shades using all the provided brackets.
2. Ensure that the brackets are properly spaced. The brackets on the two far ends of the shade should be spaced within 2" from either shade end cap. If more than two brackets were supplied, they should be spaced evenly between the two end brackets.
3. Check that the brackets are installed in a straight line across the window. If the brackets are not aligned, it can force the cassette to warp/bend when snapped into the brackets, leading to waviness in the shade.
4. Proper bracket installation will allow balance for the shade and alleviate waviness.

There is Static Between the Fabric Panels

If the shade is still showing waves through the fabric after checking the fabric alignment and the bracket installation, try running a dryer sheet between the panels, or lightly spraying liquid anti-static on the shade.