

CASSETTE 100/120 LINK BRACKET

Achieve a finished look for your roller shade by adding a sleek, gently curved cassette that is available in a range of sizes. The Cassette 100 & 120 systems are designed to work with our popular medium sized roller systems, featuring a thin lightweight extrusion which is low in cost and easy to install. With the link bracket one cassette extrusion can hold two different shades and the shades can be operated by one control, which means smaller costs per shade and simultaneous operation of two shades.

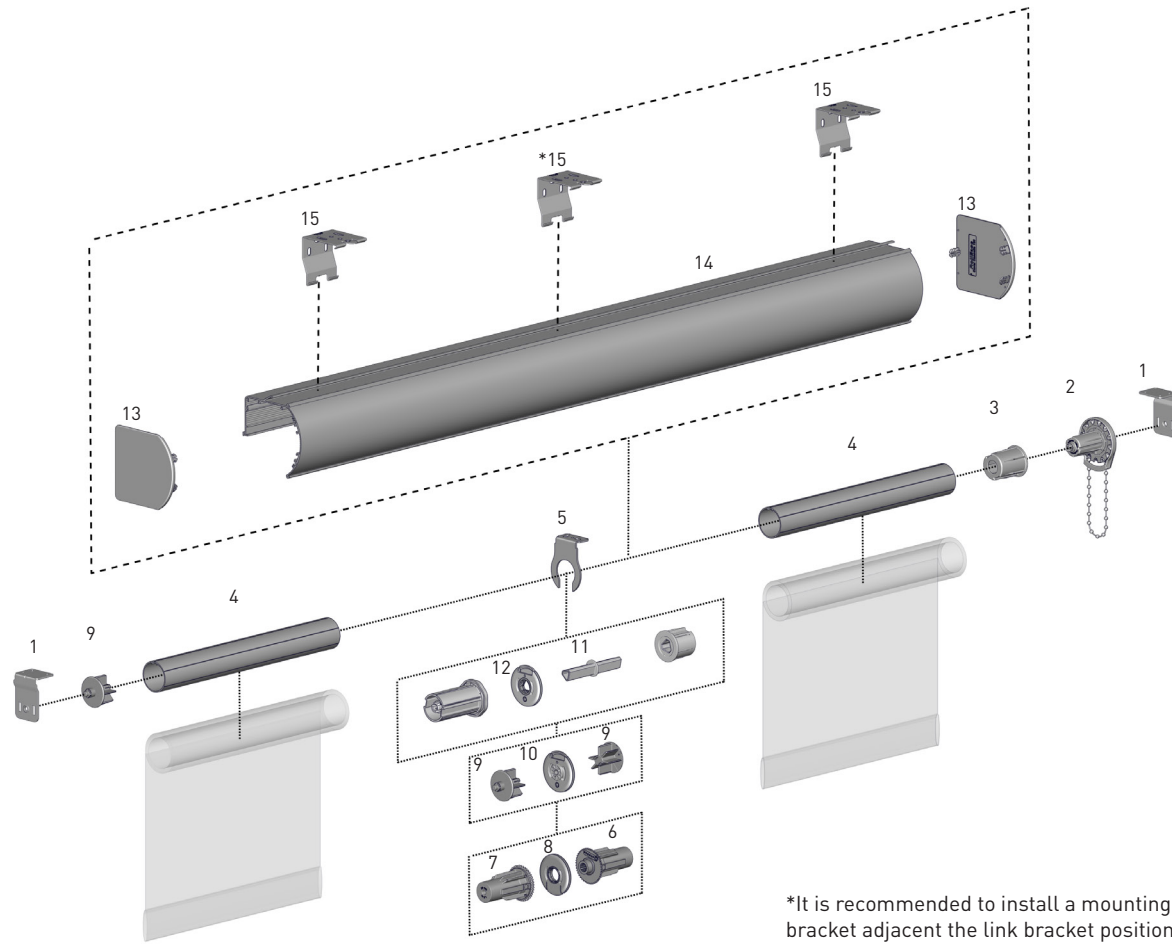

*It is recommended to install a mounting bracket adjacent the link bracket position.

SYSTEM INDEX

- 1 BRACKET FOR CASSETTE 100/120 - 38MM
CRUSLB660
- 2 CHAIN CONTROL
Refer to system Product Specifications Manual
- 3 SKYLINE ADAPTER
SLA53xx
- 4 1.5" TUBE
RTEA4T16
- 5 MEDIUM LINK SKYLINE BRACKET | NARROW | 38MM V2
RB41-0321-xxx138
- 6 MEDIUM EASY-LINK SYSTEM FEMALE DRIVE
RB41-1001-xxx038
- 7 MEDIUM EASY-LINK SYSTEM MALE DRIVE
RB41-1002-xxx038
- 8 MEDIUM EASY-LINK BRACKET BEARING
RB41-0502-xxx000
- 9 SKYLINE PIN END | 38MM
SLPEV653xx
- 10 MEDIUM LINK DISC PIN TO PIN
RB41-0503-xxx000
- 11 INFINITE ADJUSTER KIT
LSADJKITxx
- 12 BRACKET BEARING FOR INFINITE ADJUSTER
RB41-0501-xxx000
- 13a CASSETTE 100 END CAP
CREC100xx
- 13b CASSETTE 120 END CAP
SB20-0303-xxx120
- 14a CASSETTE 100 HEADRAIL
CRV100xx
- 14b CASSETTE 120 HEADRAIL
SB20-0304-020490
- 15a CASSETTE 100 MOUNTING BRACKET
SB20-0202-031100
- 15b CASSETTE 120 MOUNTING BRACKET
V2BKTxx

xxx = COLOUR, LLL = LENGTH

CONTROL OPTIONS

CHAIN CONTROL



MOTORIZED



COLOUR RANGE



white vanilla anodized black bronze

SPECIFICATIONS

MAX ROLL

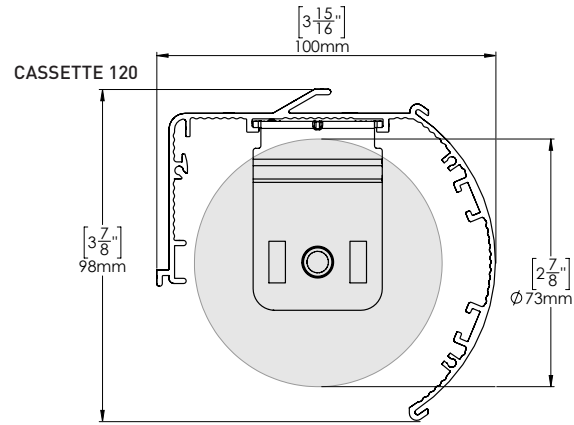
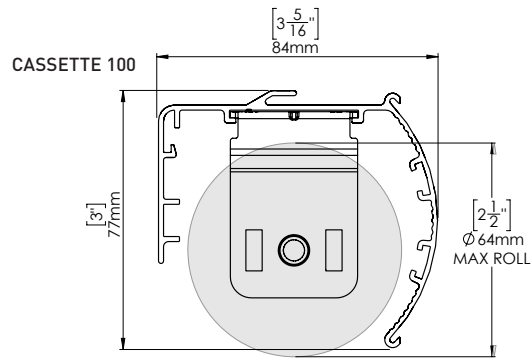

DEDUCTION

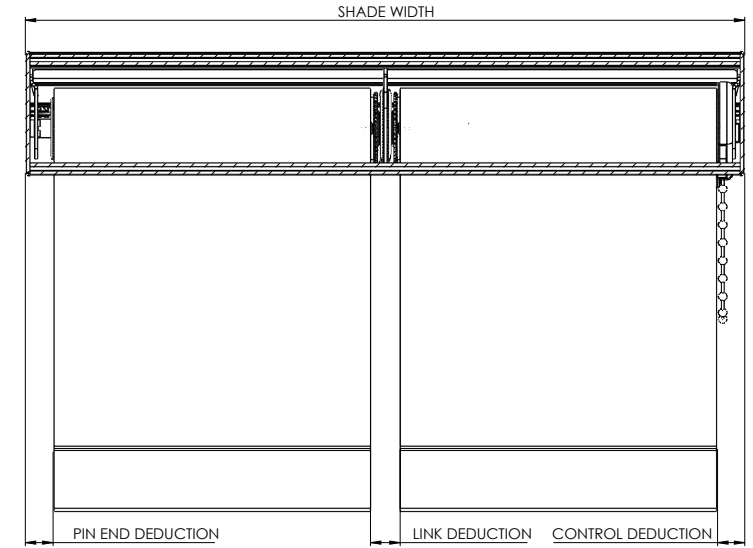

TUBE SPECS

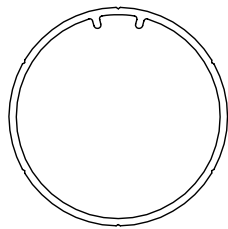

1-1/2" Tube

With tape

CODE: RTEA4TXX
OD: 38mm [1-1/2"]

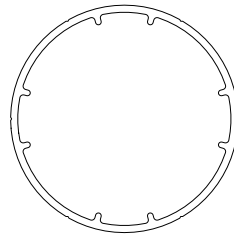

2" Tube

With tape

CODE: RTEA5TXX
OD: 51mm [2"]

LINK SYSTEM	DEDUCTION
EASY-LINK	17mm [11/16"]
SKYLINE EASY-LINK	19mm [3/4"]
INFINITE LINK	18mm [11/16"]

Note: Refer to Roll Shade Deduction Chart - Skyline for Pin & Clutch deductions